

MALDIVES LAND AND SURVEY AUTHORITY,

Ameenee Magu, Maafannu, Male', 20392, Maldives.

Office (PABX): +(960) 3004300, Fax: +(960) 3004301

Email: mlsa@housing.gov.mv

Web: www.surveyofmaldives.gov.mv



CONTROL POINT DETAILS		Station Number PSM5043
Coordinate Information		
Geodetic		Grid
WGS 84		UTM Zone 43
Lat:	04° 18' 33.1560"	E: 325149.5700
Long:	73° 25' 27.9700"	N: 476486.8300
Ellp Height:		Orth Height: +0.930 m

Date: 16th and 30th June 2012

Monument description & method of survey:

- PSM5043 monument type - Type A.
- The coordinates (E, N) is Geo referenced using *Trimble GeoExplorer (Geo XH - 2008 Series)*
- Level was determined using tide data provided by Met.

General site condition & access:

- PSM5043 was to be established in the vegetation line of the island.
- PSM5043 is located on Kaafu Vabbinfaru on the Sothern edge of the island near Arrival Jetty.
- PSM5043 is located in an area which is easy to access and locate.

Owner: *Vabbinvest Maldives Pvt Ltd*



DOWN VIEW

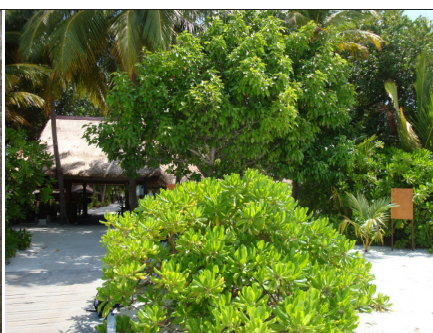

NORTH VIEW



EAST VIEW



TOP VIEW



SOUTH VIEW



WEST VIEW

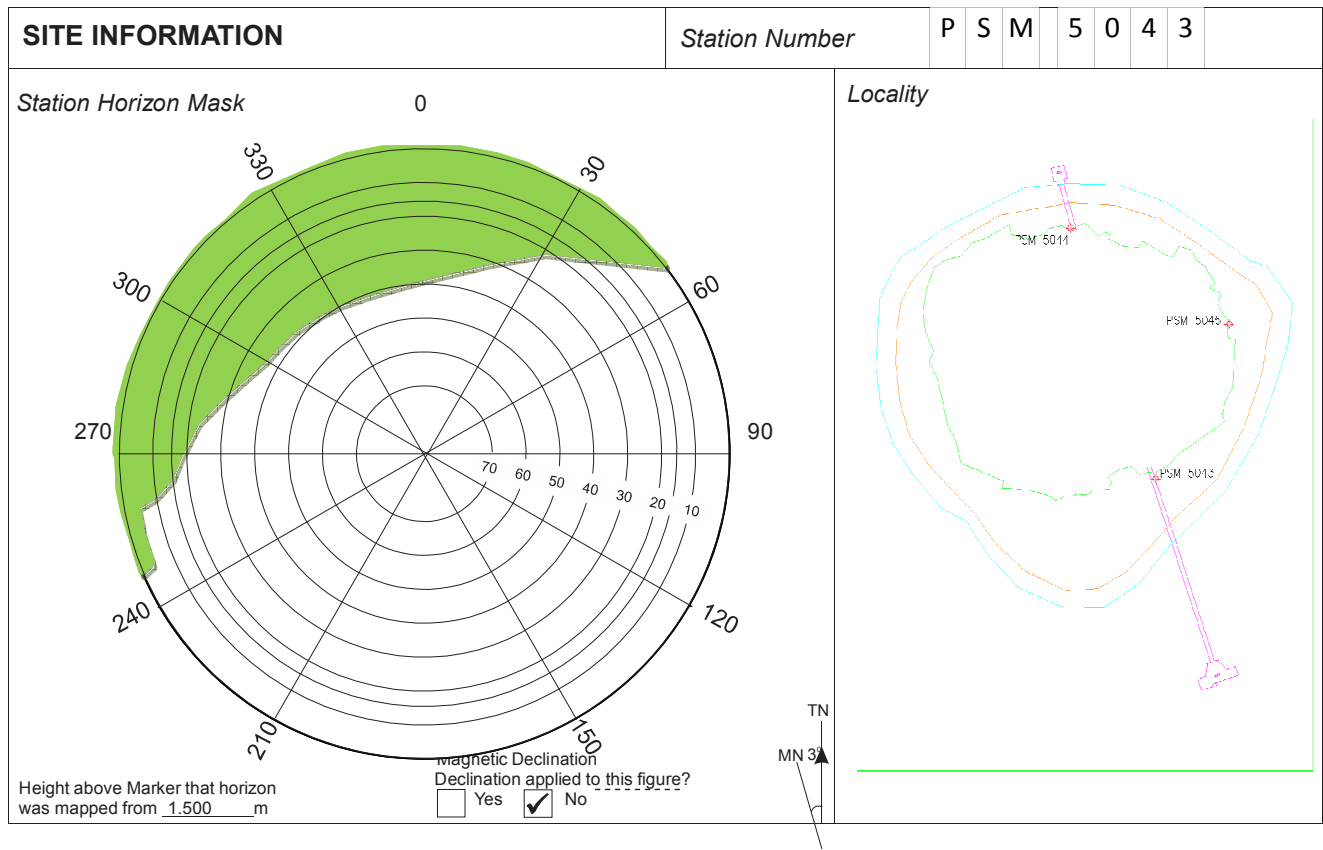

MALDIVES LAND AND SURVEY AUTHORITY,

Ameenee Magu, Maafannu, Male', 20392, Maldives.

Office (PABX): +(960) 3004300, Fax: +(960) 3004301

Email: mlsa@housing.gov.mv

Web: www.surveyofmaldives.gov.mv



CONTROL POINT DETAILS	Station Number PSM5044
Coordinate Information	
Geodetic	Grid
WGS 84	UTM Zone 43
Lat: 04° 18' 38.2644"	E: 325096.4291
Long: 73° 25' 26.2340"	N: 476643.8674
Ellp Height:	Orth Height: +1.753 m

Date: 16th and 30th June 2012

Monument description & method of survey:

- PSM5044 monument type - Type A.
- The coordinates (E, N) is derived after computation using PSM 5043
- Level was determined using tide data provided by Met.

General site condition & access:

- PSM5044 was to be established in the vegetation line of the island.
- PSM5044 is located on Kaafu Vabbinfaru on the Northern edge of the island near the Jetty.
- PSM5044 is located in an area which is easy to access and locate.

Owner: Vabbinvest Maldives Pvt Ltd



DOWN VIEW



NORTH VIEW



EAST VIEW



TOP VIEW



SOUTH VIEW



WEST VIEW

SITE INFORMATION

Station Number

P S M 5 0 4 4

Station Horizon Mask

0

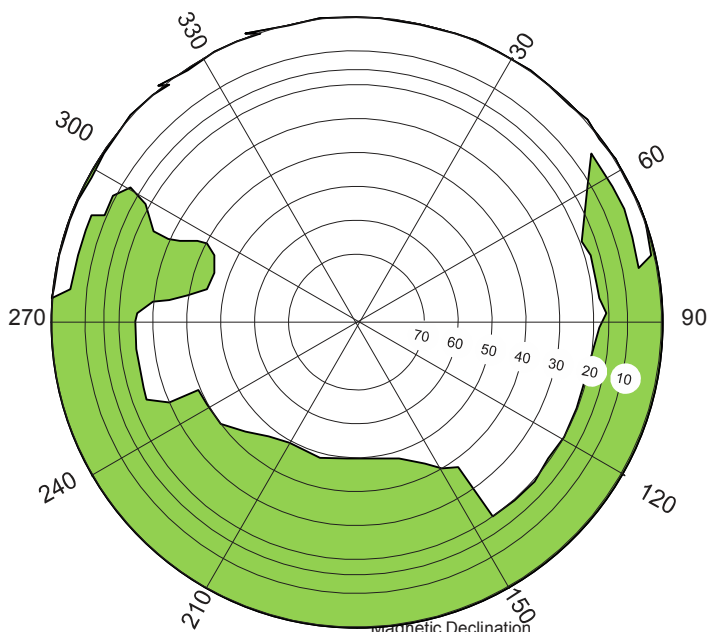

Height above Marker that horizon was mapped from 1.500 m

Magnetic Declination
Declination applied to this figure?
Yes No

☐ ☒

MN3

Locality

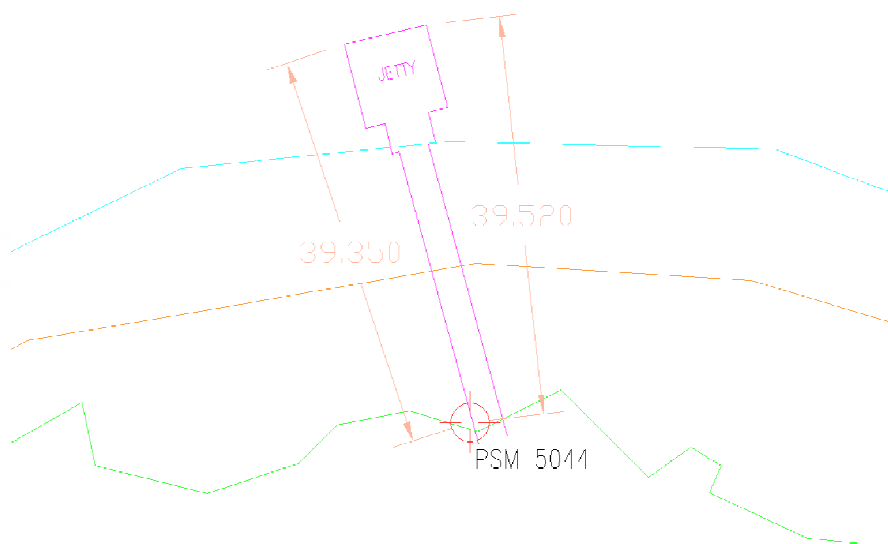
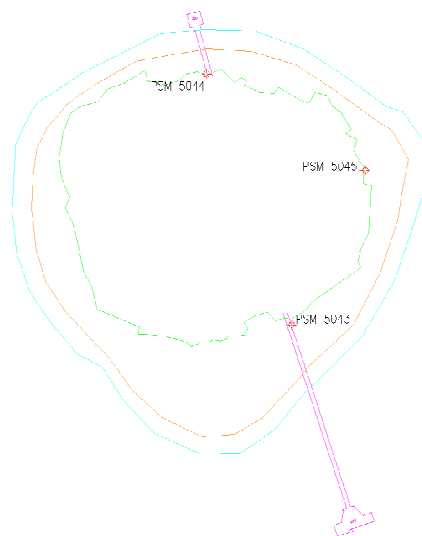

MALDIVES LAND AND SURVEY AUTHORITY,

Ameenee Magu, Maafannu, Male', 20392, Maldives.

Office (PABX): +(960) 3004300, Fax: +(960) 3004301

Email: mlsa@housing.gov.mv

Web: www.surveyofmaldives.gov.mv



CONTROL POINT DETAILS	Station Number PSM5045
Coordinate Information	
Geodetic	Grid
WGS 84	UTM Zone 43
Lat: 04° 18' 36.3096"	E: 325195.5763
Long: 73° 25' 29.4560"	N: 476583.5888
Ellp Height:	Orth Height: +1.164 m

Date: 16th and 30th June 2012

Monument description & method of survey:

- PSM 5045 monument type - Type A.
- The coordinates (E, N) is derived after computation using PSM 5043
- Level was determined using tide data provided by Met.

General site condition & access:

- PSM5045 was to be established in the vegetation line of the island.
- PSM5045 is located on Kaafu Vabbinfaru on the Eastern edge of the island.
- PSM5045 is located in an area which is easy to access and locate.

Owner: Vabbinvest Maldives Pvt Ltd



DOWN VIEW



NORTH VIEW



EAST VIEW



TOP VIEW



SOUTH VIEW



WEST VIEW

SITE INFORMATION

Station Number

P S M 5 0 4 5

Station Horizon Mask

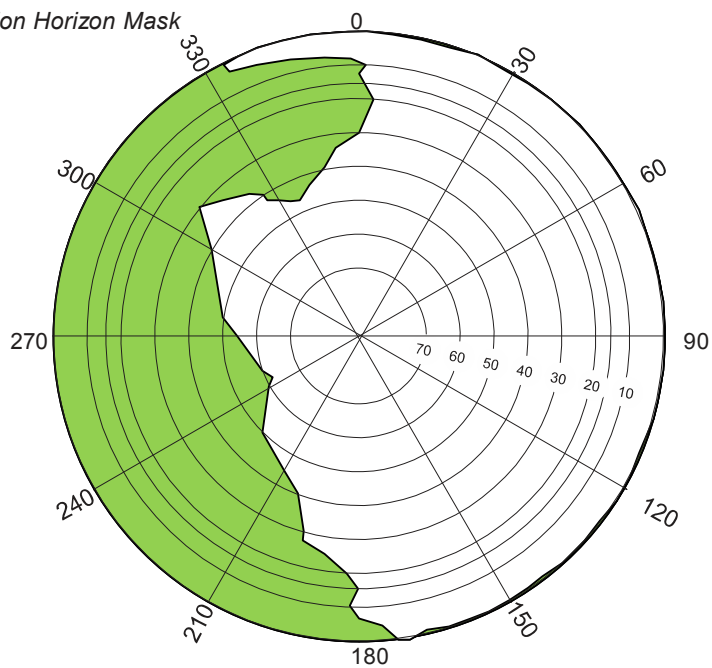

Height above Marker that horizon was mapped from 1.500 m

Magnetic Declination
Declination applied to this figure?
☐ Yes ☒ No



Locality

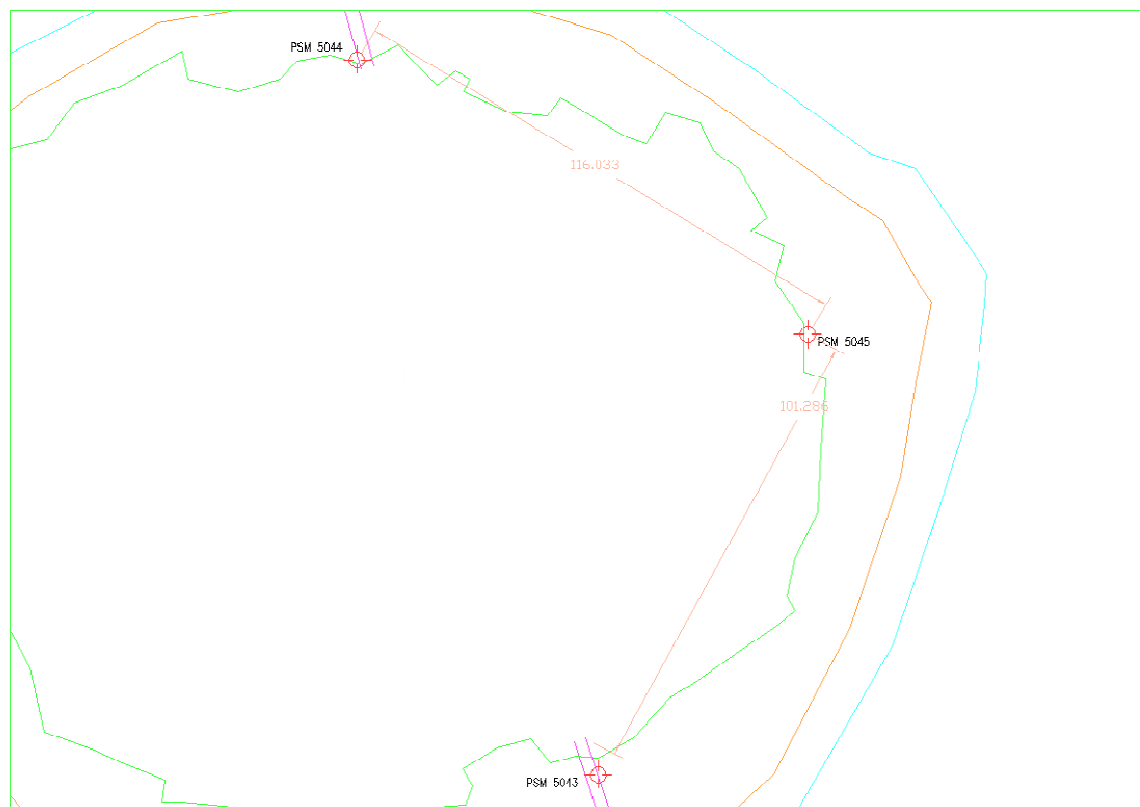
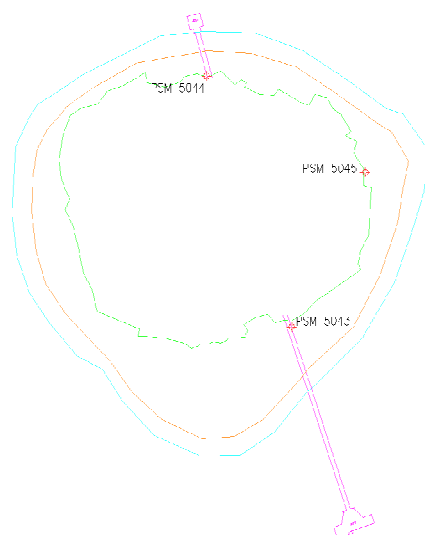

Sketched by: Hazim Rasheed (Hardy)

Scale: Not to scale

Date: 14th November 2012